

Modulus Twin Pole Double Span Table

Installation Guide

TOOLS REQUIRED: Powered screwdriver.

Modulus 4 Post Pedestal Table

INSTALLATION GUIDE



Office Link Group.

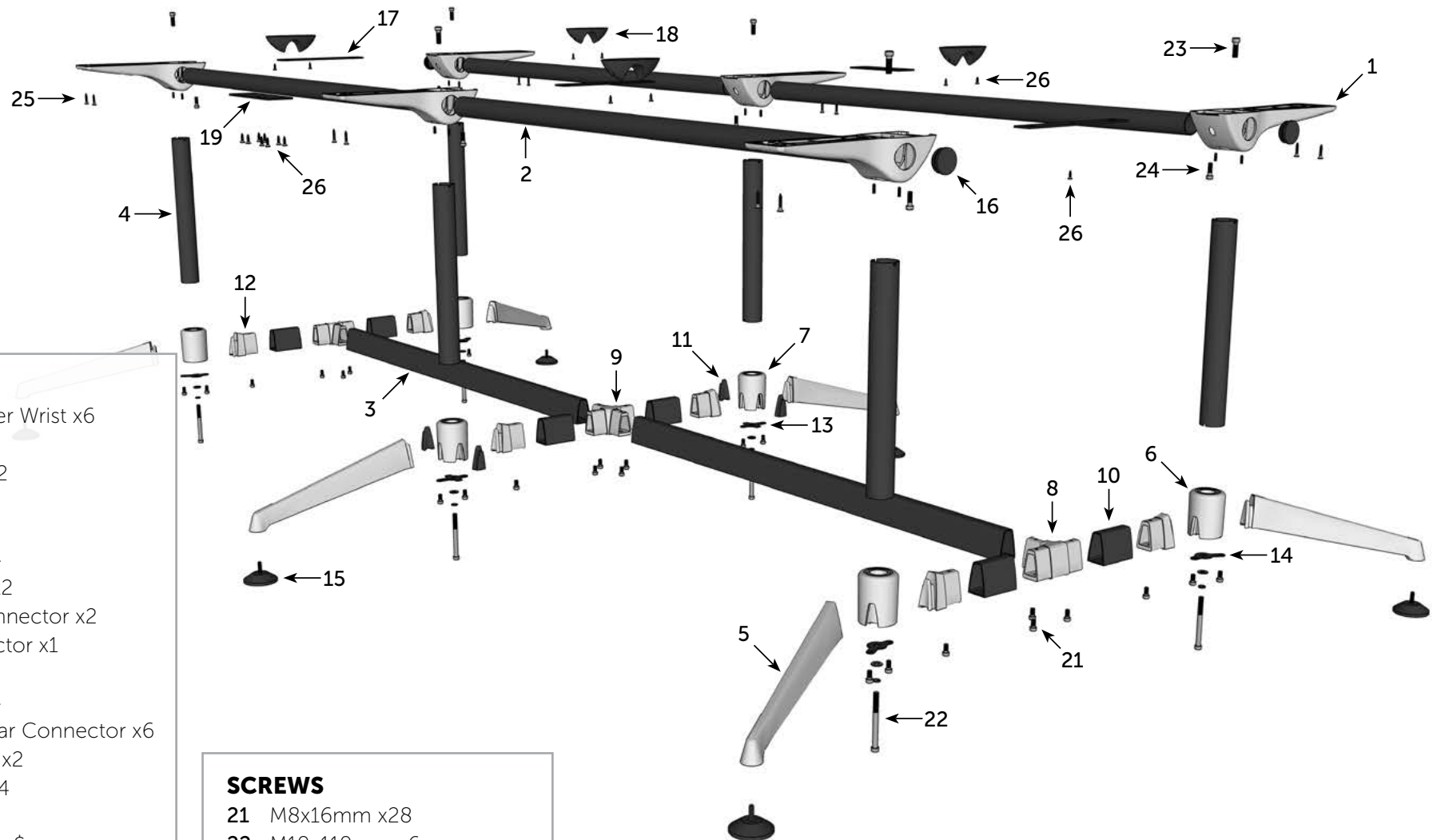

COMPONENTS

- 1 Die Cast Upper Wrist x6
- 2 Top Rail x4
- 3 Bottom Rail x2
- 4 Feet Tube x6
- 5 Large Foot x6
- 6 150° Collar x4
- 7 Cross Collar x2
- 8 Bottom T Connector x2
- 9 Cross Connector x1
- 10 T Tube x6
- 11 Collar Plug x4
- 12 T Tube & Collar Connector x6
- 13 Minus Gasket x2
- 14 150° Gasket x4
- 15 Foot Glide x6
- 16 Top Rail Caps x\$
- 17 Steel Strap x3
- 18 Plastic Support x4
- 19 Table Top Bracket Plate x2
- 20 Table Top x2

SCREWS

- 21 M8x16mm x28
- 22 M10x110mm x6
- 23 M10x30mm x6
- 24 M8x25mm x6
- 25 M5x30mm Self Tapping x12
- 26 M5x20mm x47

Modulus 4 Post Pedestal Table

INSTALLATION GUIDE

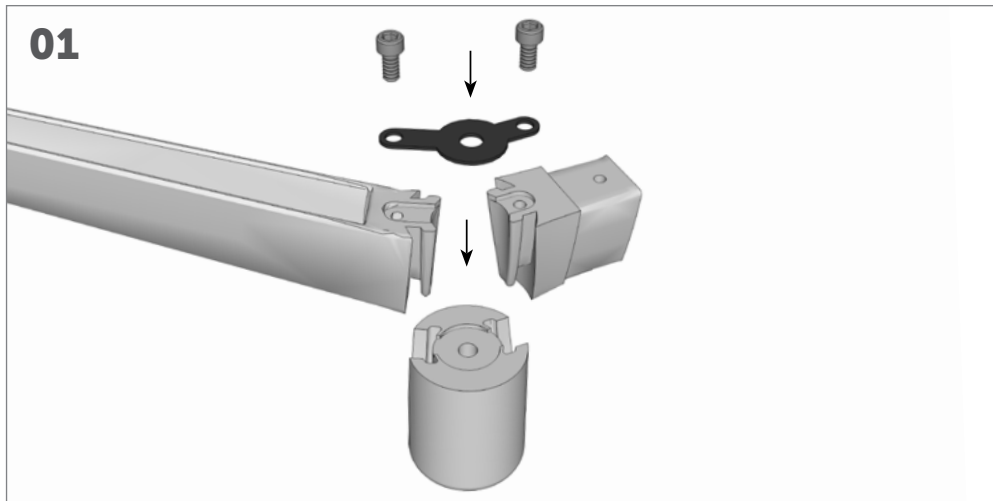

Slide the large foot and T tube connector into the collar, place the 150° gasket on top, and fully tighten the 2 M8x16mm bolts into the collar. *(Repeat with all 150° collars)*

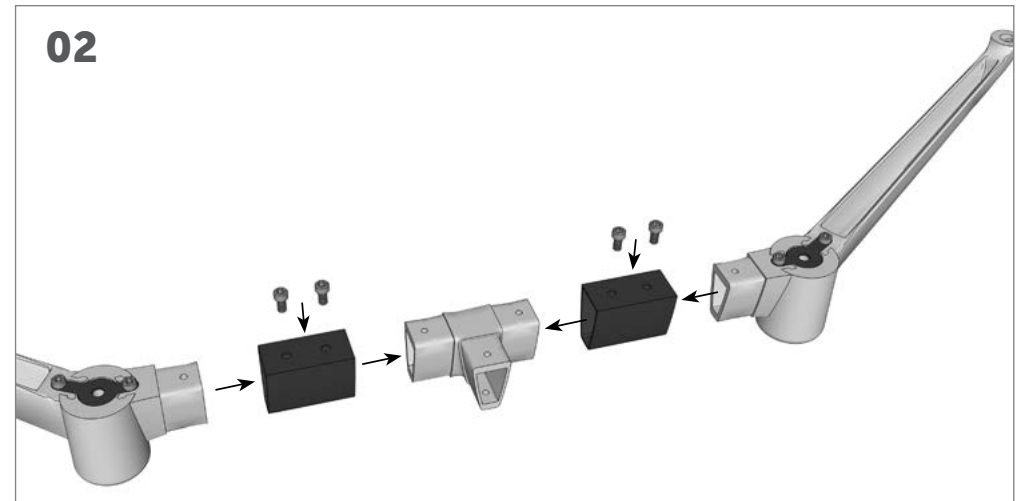

Using 2 T tubes, connect the assembled corner feet to the bottom T connector, and fully tighten the 4 M8x16mm bolts. *(Repeat with all 150° feet)*



Slide the large foot, T tube connector and 2 cross collar plugs into the collar, place the minus gasket on top, and fully tighten the 2 M8x16mm bolts into the collar. *(Repeat with all cross collars)*

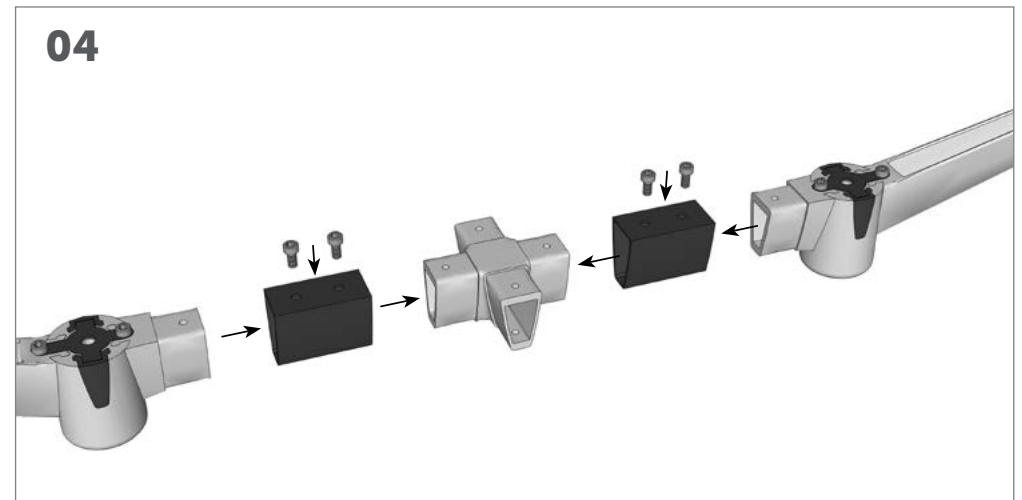

Using 2 T tubes, connect the assembled centre feet to the bottom cross connector, and fully tighten the 4 M8x16mm bolts.

Modulus 4 Post Pedestal Table

INSTALLATION GUIDE

05



Screw all glides into the base of the large feet, leaving the glides one turn from tight (then they can be adjusted easily if the floor is uneven).

06

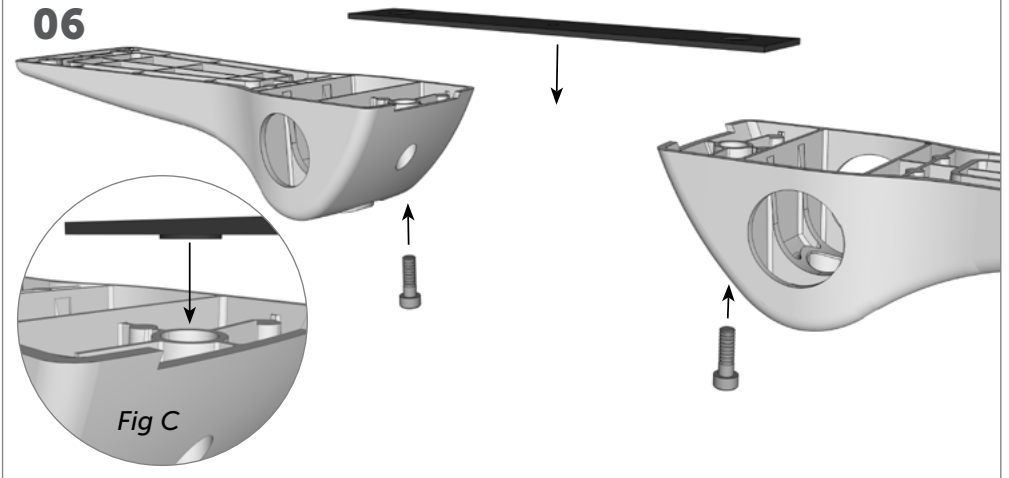

Place the steel strap onto the upper wrists, with the raised areas of the straps slotting into the holes on the upper wrist, **Fig C**. Fully tighten the M8x25mm bolts. *(Repeat with all upper wrists and steel straps)*

07

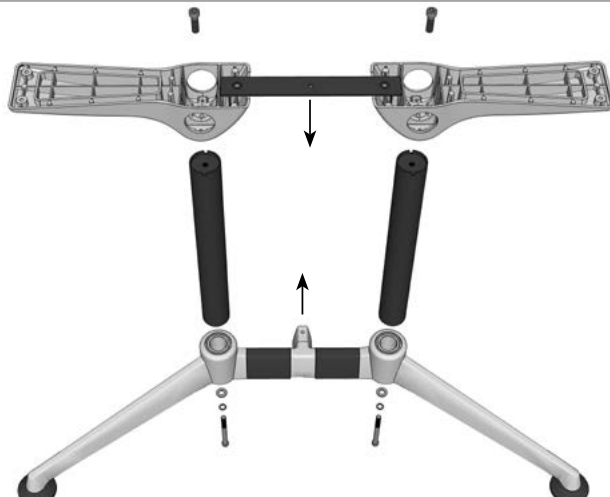

Place a feet tube on top of each collar, and the upper wrist assembly on top of the feet tubes. Fully tighten the M10x30mm bolts through the upper wrists, and M10x110mm bolt, spring washer and flat washer through the collars.

08



Place all assembled leg sets together using the bottom rails, and fully tighten the M8x16mm bolts to lock all legs together.

Modulus 4 Post Pedestal Table

INSTALLATION GUIDE

09



Slide each top rail through the upper wrists, making sure they are located in the centre of the frame.

10

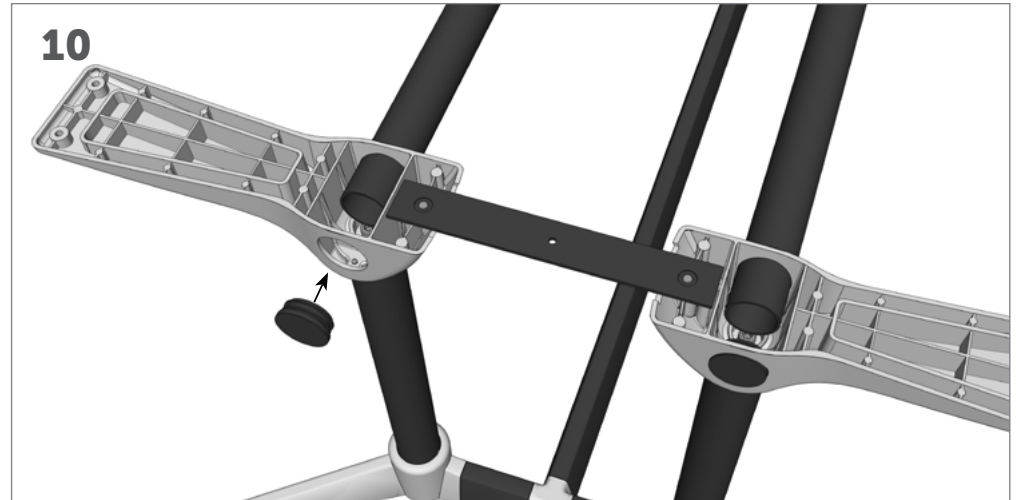

Place the top rail caps into the exposed holes on each end of the frame assembly.

11

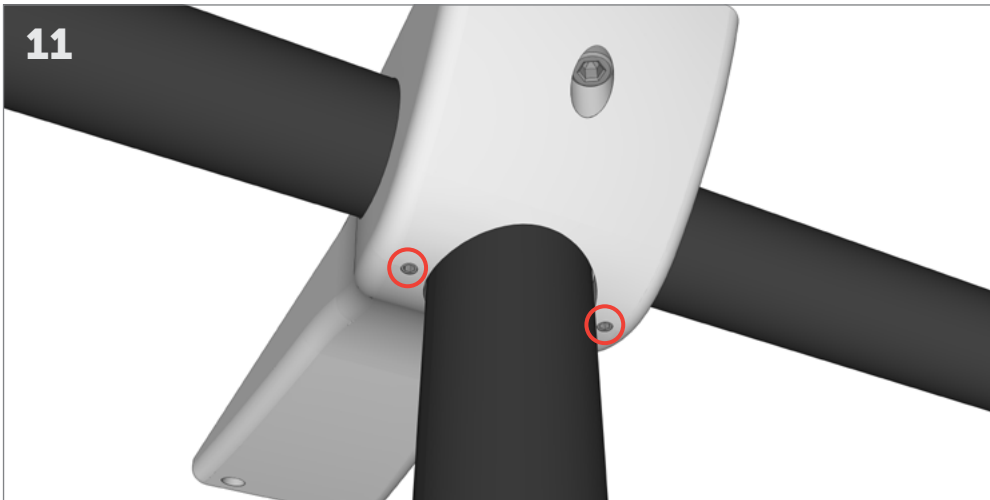

Tighten all small grub screws located on the bottom of each upper wrist.

12

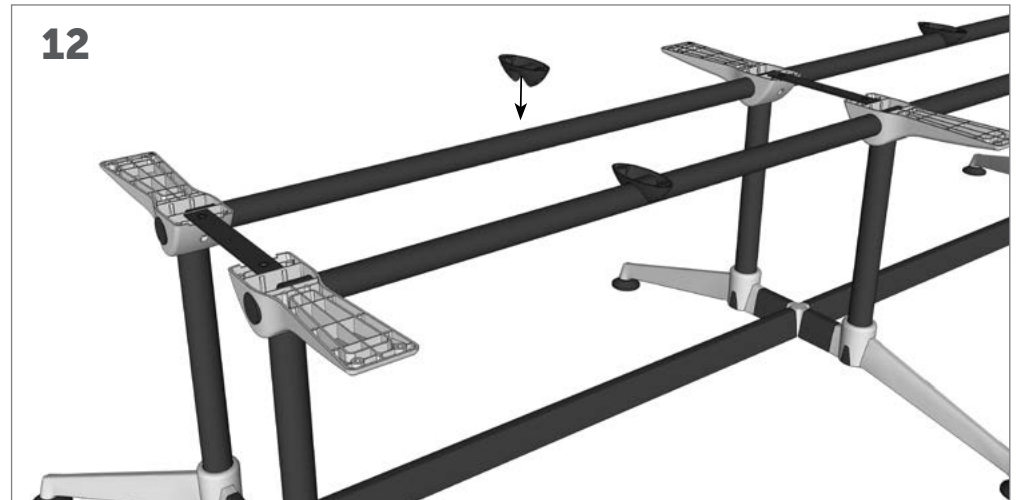

Snap the plastic support brackets onto the centre of each top rail. The frame assembly is now complete.

Modulus 4 Post Pedestal Table

INSTALLATION GUIDE

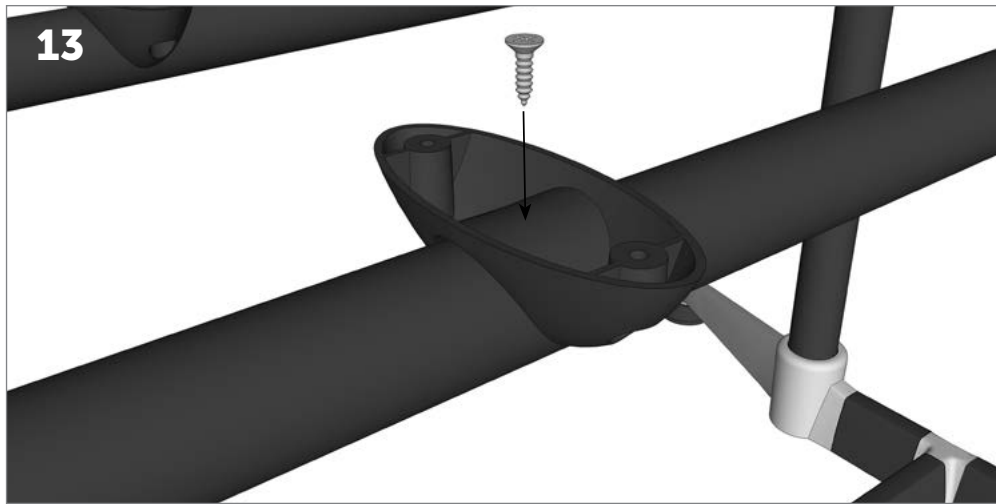

Optional: For extra strength, the plastic support brackets can be screwed onto the top rails.

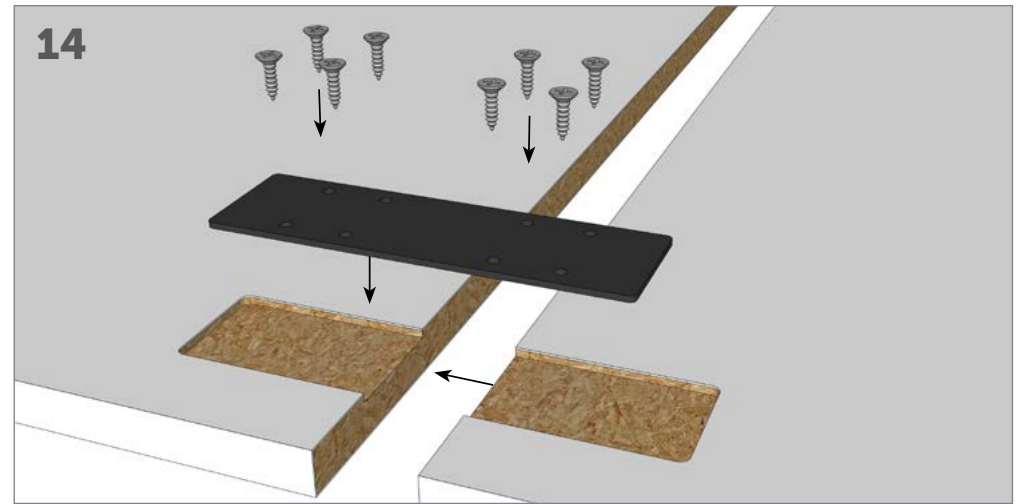

For multi piece work surfaces, use the table top bracket plates, and M5x20mm screws to join together as one solid piece. This should be done with the work surface sitting on the frame in its final position.

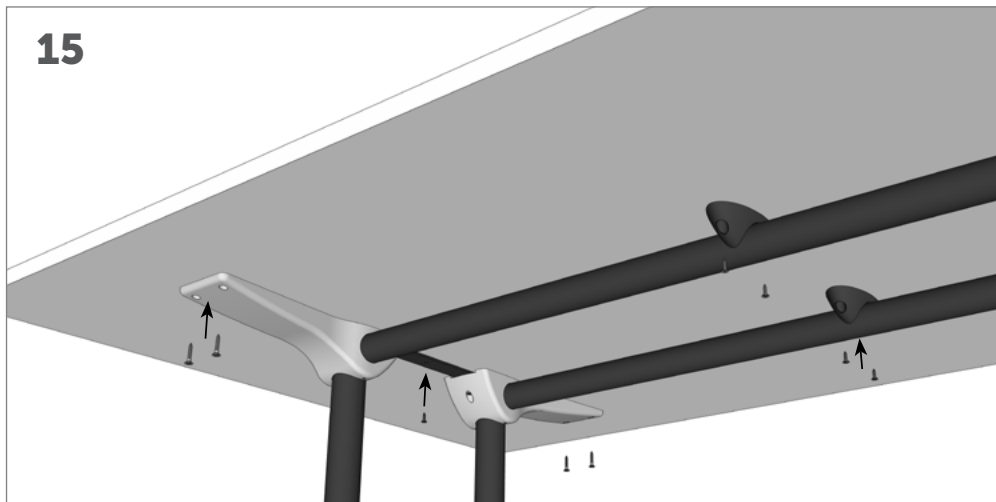

Fully tighten all M5x30mm screws through each upper wrist into the work surface. Fully tighten all M5x20mm screws through each steel strap and plastic support into the work surface.

